

Municipality of Harrison Park
UNDER THE AUTHORITY OF THE PLANNING ACT
NOTICE OF PUBLIC HEARING.

On the date and at the time and location shown below, a PUBLIC HEARING will be held to receive representations from any persons who wish to make them in respect to the following matter:

APPLICATION FOR CONDITIONAL USE ORDER under the RM of PARK BY-LAW 1311 as amended.

HEARING: Council Chambers at Municipal Office,
43 Gateway Street, Onanole, Manitoba

To participate in the public hearing via Zoom, please contact the Municipal Office in advance of the hearing at 204-848-7614 for details.

DATE & TIME: December 14th, 2022 - 2:30 p.m.

APPLICATION: 2022 STR CU -11

OWNER(S): Bev Towler

PROPOSAL To allow the use of a Boarding and Rooming House in the "RG" Residential General Zone under RM of Park Zoning By-Law 1311 Part 7, 7-1 Urban Use Table.
To be operated as a short-term rental.

AREA AFFECTED: Unit 161 – 80 Timothy RD
161 Poplar bay, Grey Owl Resort

FOR INFORMATION CONTACT: Robert Ewashko, Development Officer
Phone: 204-848-2561
Email: Robert@harrisonpark.ca

A copy of the above proposal and supporting material may be inspected or copied at the location noted above during normal office hours, Monday to Friday.

Land Use and Development Map



11/28/2022, 9:52:24 AM

Property Assessment Information

Manitoba Boundary

1:4,514

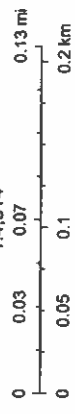

Esri Community Maps Contributors, Province of Manitoba, Esri Canada, Esri, HERE, Garmin, SafeGraph, GeoTechnologies, Inc. METANASA, USGS, EPA, US Census Bureau, USDA, NRCAN, Parks Canada, Maxar

Source: Esri, Maxar, Earthstar Geographics, and the GIS User Community | Maxar | Esri Community Maps Contributors, Province of Manitoba, Esri Canada, Esri, HERE, Garmin, SafeGraph, GeoTechnologies, Inc. METANASA, USGS, EPA, US Census Bureau, USDA, NRCAN, Parks Canada |



Trees



Trees

parking

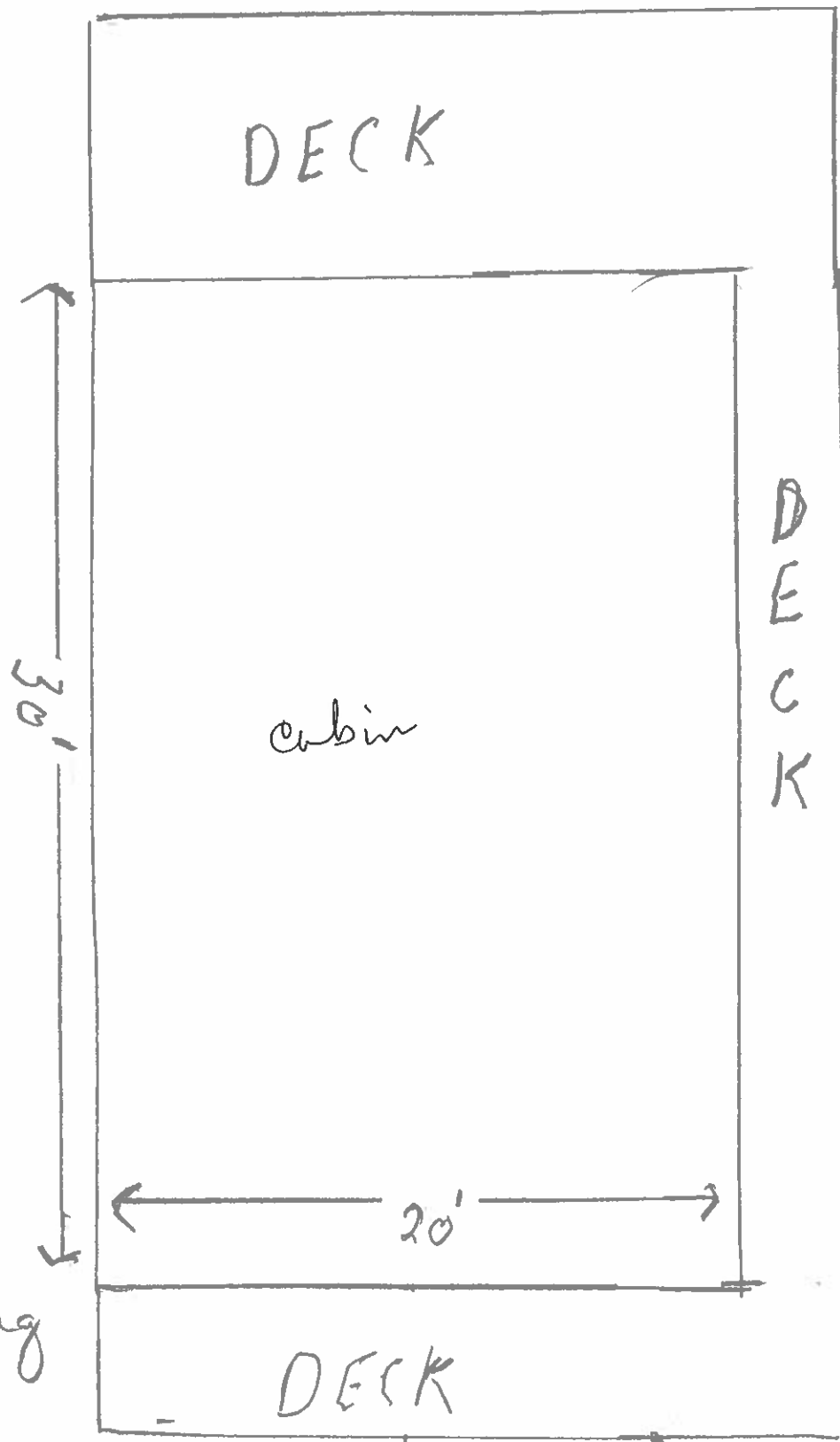

Lot size

60x85



MUNICIPALITY OF HARRISON PARK

Head Office:

Box 190
43 Gateway Street
Onanole, MB R0J 1N0
Phone: 204-848-7614
Fax: 204-848-2082

Satellite Office:

Box 220
108 Main Street
Newdale, MB R0J 1J0
Phone: 204-849-2107
Fax: 204-849-2190

Public Hearing Commonly Asked Questions

Why did I receive this notice?

Section 169 of *The Planning Act*, requires that owners of property located within 100 meters of the affected property receive a copy of the notice of the hearing.

What is the main objective of the hearing?

At the time and date of the hearing, the Chairperson will ask the applicant to speak about the application and then Council may ask questions. After that the Chairperson will ask if anyone would like to speak for or against the application.

This is your opportunity to make representations to Council regarding the proposed application.

When the hearing is concluded, there are no further chances for anyone to speak to the Council of this matter.

Do I have to attend the hearing?

Your attendance at the Public Hearing is welcomed, however, you are not required to attend.

What if I have objections?

Objections can be raised in person at the public hearing or by submitting the objections in writing to:

Mail: Box 190, Onanole, MB R0J 1N0

Email: robert@harrisonpark.ca

Fax: 204-848-2082

All objections must be received prior to the conclusion of the hearing.

What if I have something to say but cannot attend the hearing?

You may submit written comments to the Municipality, but they must be received prior to the conclusion of the hearing.

Mail: Box 190, Onanole, MB R0J 1N0

Email: robert@harrisonpark.ca

Fax: 204-848-2082

Please be advised that all correspondence received in conjunction with, or as a result of, an application that requires Council approval becomes public information therefore personal information contained in the correspondence is released in the public domain.

Decision of Council after Public Hearing?

After the hearing and consideration of the application, Council shall either approve or reject this application.

Where can I get more information?

If you would like more information on the application, please call Robert Ewashko, Building Official at 204-848-2561. Copies of supporting materials are available for inspection at the Municipal Office located at 43 Gateway Street, Onanole, MB.